

**This electronic collection of documents is provided  
for the convenience of the user  
and is Not a Certified Document –**

**The documents contained herein were originally issued  
and sealed by the individuals whose names and license  
numbers appear on each page, on the dates appearing  
with their signature on that page.**

**This file or an individual page  
shall not be considered a certified document.**

PROJECT REFERENCE NO.	SHEET NO.
2024CPT.07.06.20172, ETC.	1

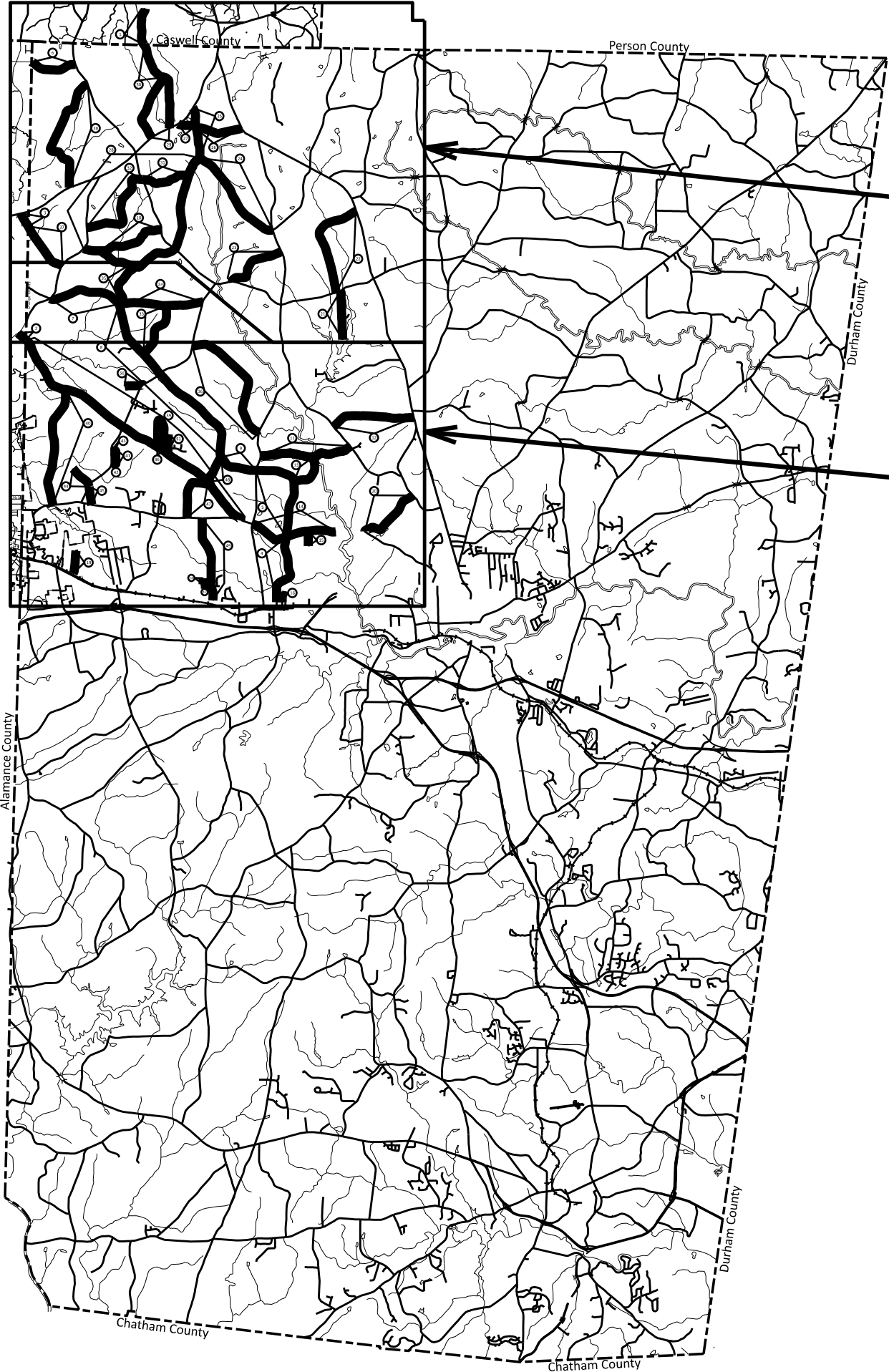

Sheet  
No. 2

Sheet  
No. 3



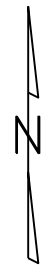
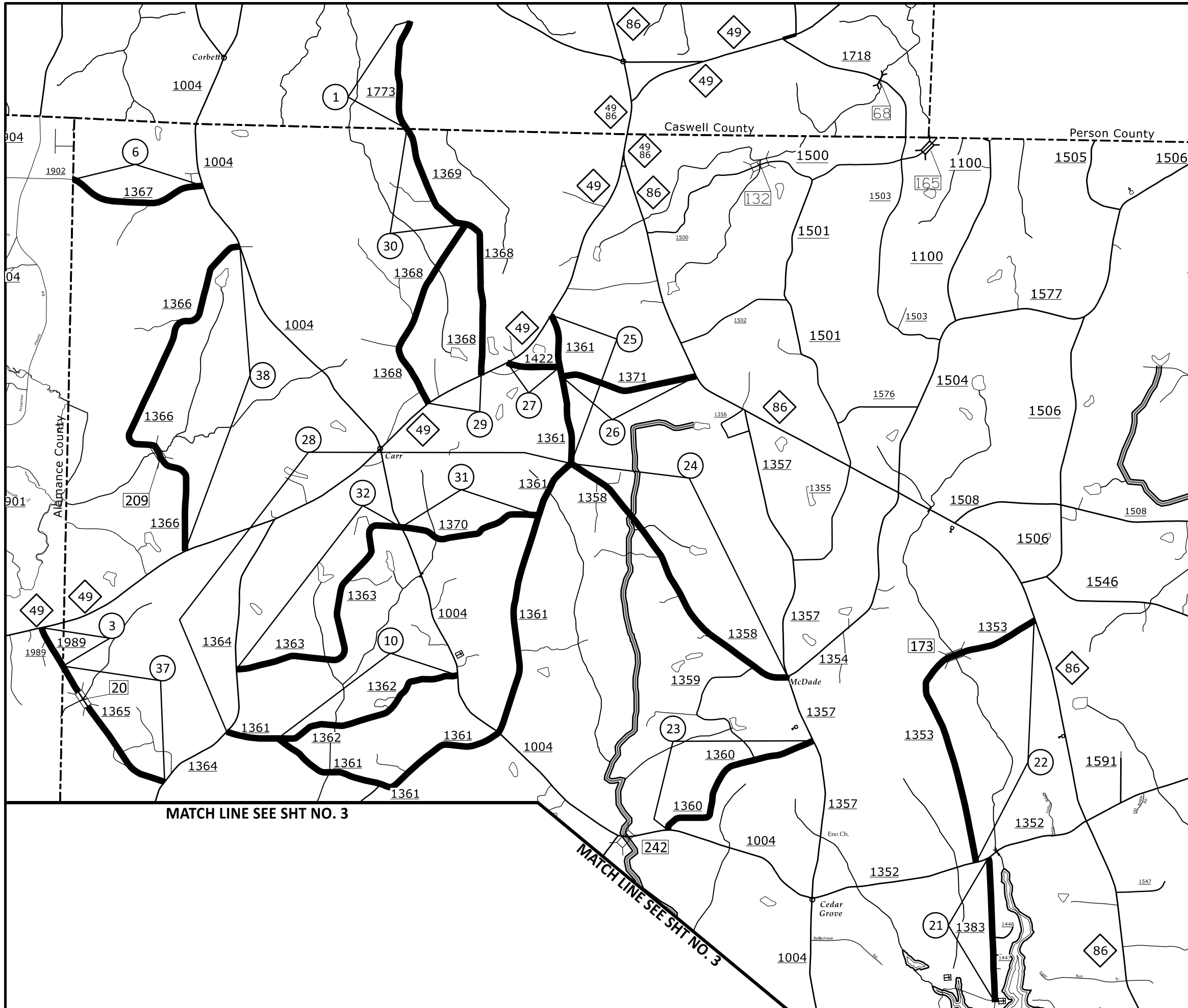

- Map 1** SR 1773 - Wade Dead End Rd
- Map 3** SR 1989 - Mt Zion Church Rd
- Map 6** SR 1367 - Claibornes Rd
- Map 10** SR 1362 - Allie Mae Rd
- Map 21** SR 1383 - Eno Cemetery Rd
- Map 22** SR 1353 - Compton Rd  
Bridge #173 Resurface  
No Posting
- Map 23** SR 1360 - Lees Chapel Rd
- Map 24** SR 1358 - Mcdade Store Rd
- Map 25** SR 1361 - Mcdade Store Rd
- Map 26** SR 1371 - Mccullough Rd
- Map 27** SR 1422 - Mccullough Rd
- Map 28** SR 1361 - Penecost Rd
- Map 29** SR 1368 - Wade Loop
- Map 30** SR 1369 - Wades Dead End
- Map 31** SR 1370 - Doc Corbett Rd
- Map 32** SR 1363 - Doc Corbett Rd
  
- Map 37** SR 1365 - Mt Zion Church Rd  
Bridge #20 NO PAVEMENT ON BRIDGE  
Posted 26/NP
- Map 38** SR 1366 - Atkins Rd

MATCH LINE SEE SHT NO. 3

MATCH LINE SEE SHT NO. 3

MATCH LINE SEE SHT NO. 3

**ORANGE COUNTY**  
NORTH CAROLINA

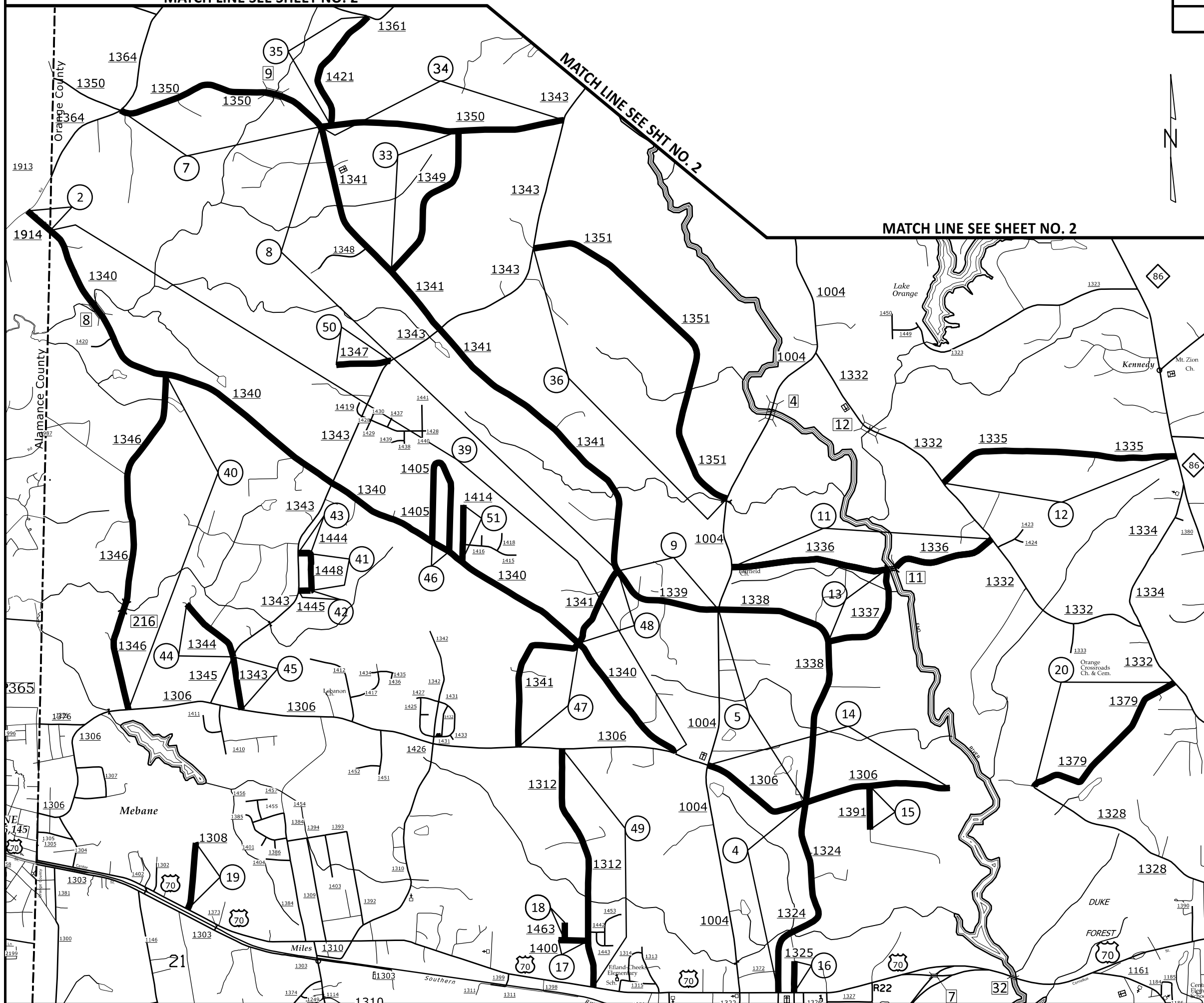

- Map 2** SR 1914 - High Rock Rd
- Map 4** SR 1324 - Brookhollow Rd
- Map 5** SR 1338 - Brookhollow Rd
- Map 7** SR 1350 - Harmony Church Rd  
Bridge #9 Resurface  
No Posting
- Map 8** SR 1341 - Harmony Church Rd
- Map 9** SR 1339 - Harmony Church Rd
- Map 11** SR 1336 - Halls Mill Rd  
Bridge #11 No Pavement on Bridge  
Posted 22/29
- Map 12** SR 1335 - Kenion Rd
- Map 13** SR 1337 - Bane Rd
- Map 14** SR 1306 - Lebanon Rd
- Map 15** SR 1391 - Blacksmith Rd
- Map 16** SR 1325 - North Oak St
- Map 17** SR 1400 - Gregg St
- Map 18** SR 1463 - Cain Dr
- Map 19** SR 1308 - Hoover Rd
- Map 20** SR 1379 - Frank Perry Rd
- Map 33** SR 1349 - Poteat Rd
- Map 34** SR 1350 - Lonesome Rd
- Map 35** SR 1421 - Lib Rd
- Map 36** SR 1351 - Governor Scott Rd
- Map 39** SR 1340 - High Rock Rd  
Bridge # 8 Resurface  
No Posting
- Map 40** SR 1346 - Saddle Club Rd  
Bridge # 216 Resurface  
No Posting
- Map 41** SR 1448 - Tanya Drive
- Map 42** SR 1445 - Glenn Court
- Map 43** SR 1444 - Cherry Street
- Map 44** SR 1344 - Doe Run
- Map 45** SR 1343 - Doe Run
- Map 46** SR 1405 - Poplar Dr / Maple Ave
- Map 47** SR 1341 - Ira Rd
- Map 48** SR 1341 - Ira Rd
- Map 49** SR 1312 - Richmond Rd
- Map 50** SR 1347 - Charlies Deadend Rd
- Map 51** SR 1414 - Poplar Drive

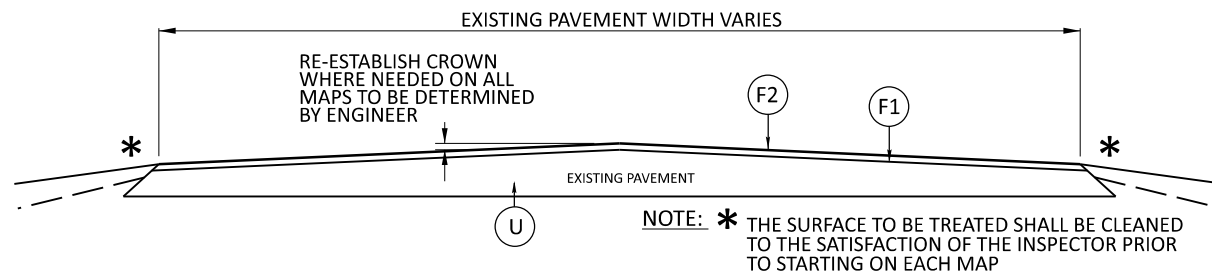

**TYPICAL SECTION NO. 1**

Map 1	SR 1773 - Wade Dead End Rd	Map 27	SR 1422 - Mccullough Rd
Map 2	SR 1914 - High Rock Rd	Map 28	SR 1361 - Penecost Rd
Map 3	SR 1989 - Mt Zion Church Rd	Map 29	SR 1368 - Wade Loop
Map 4	SR 1324 - Brookhollow Rd	Map 30	SR 1369 - Wades Dead End
Map 5	SR 1338 - Brookhollow Rd	Map 31	SR 1370 - Doc Corbett Rd
Map 6	SR 1367 - Claibornes Rd	Map 32	SR 1363 - Doc Corbett Rd
Map 7	SR 1350 - Harmony Church Rd	Map 33	SR 1349 - Poteat Rd
	Bridge #9 Resurface	Map 34	SR 1350 - Lonesome Rd
	No Posting	Map 35	SR 1421 - Lib Rd
Map 8	SR 1341 - Harmony Church Rd	Map 36	SR 1351 - Governor Scott Rd
Map 9	SR 1339 - Harmony Church Rd	Map 37	SR 1365 - Mt Zion Church Rd
Map 10	SR 1362 - Allie Mae Rd		Bridge #20 NO PAVEMENT ON BRIDGE
Map 11	SR 1336 - Halls Mill Rd		Posted 26/NP
	Bridge #11 No Pavement on Bridge	Map 38	SR 1366 - Atkins Rd
	Posted 22/29	Map 39	SR 1340 - High Rock Rd
Map 12	SR 1335 - Kenion Rd		Bridge # 8 Resurface
Map 13	SR 1337 - Bane Rd		No Posting
Map 14	SR 1306 - Lebanon Rd	Map 40	SR 1346 - Saddle Club Rd
Map 15	SR 1391 - Blacksmith Rd		Bridge # 216 Resurface
Map 16	SR 1325 - North Oak St		No Posting
Map 17	SR 1400 - Gregg St	Map 41	SR 1448 - Tanya Drive
Map 18	SR 1463 - Cain Dr	Map 42	SR 1445 - Glenn Court
Map 19	SR 1308 - Hoover Rd	Map 43	SR 1444 - Cherry Street
Map 20	SR 1379 - Frank Perry Rd	Map 44	SR 1344 - Doe Run
Map 21	SR 1383 - Eno Cemetery Rd	Map 45	SR 1343 - Doe Run
Map 22	SR 1353 - Compton Rd	Map 46	SR 1405 - Poplar Dr / Maple Ave
	Bridge #173 Resurface	Map 47	SR 1341 - Ira Rd
	No Posting	Map 48	SR 1341 - Ira Rd
Map 23	SR 1360 - Lees Chapel Rd	Map 49	SR 1312 - Richmond Rd
Map 24	SR 1358 - Mcdade Store Rd	Map 50	SR 1347 - Charlies Deadend Rd
Map 25	SR 1361 - Mcdade Store Rd	Map 51	SR 1414 - Poplar Drive
Map 26	SR 1371 - Mccullough Rd		

NOTE: NON-SYSTEM = (CITY STREET, PRIVATE DRIVE, SCHOOL BUS DRIVE)

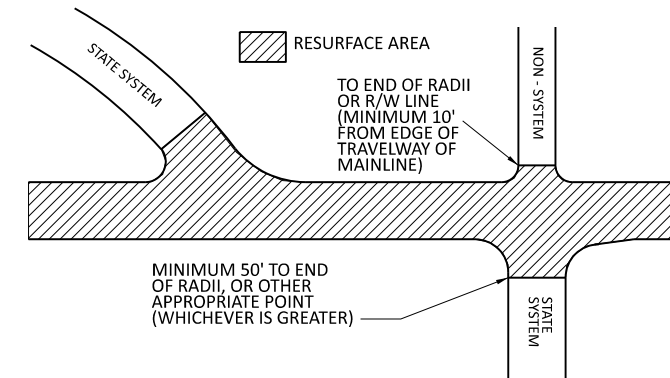

**PAVING DETAIL 1  
MAIN LINE IS BEING RESURFACED**

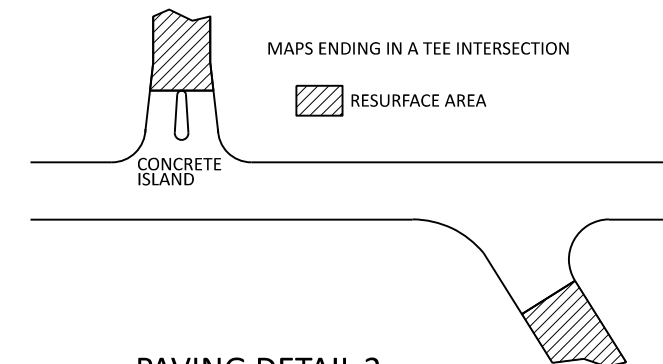

**PAVING DETAIL 2  
MAIN LINE NOT BEING RESURFACED**

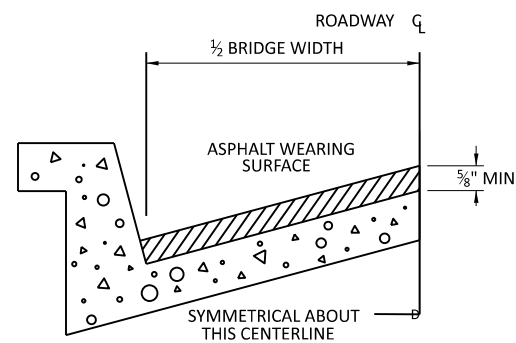

**BRIDGE HALF TYPICAL SECTION**

FOR BRIDGES WITH FLOOR DRAINS, CARE SHALL BE EXERCISED IN PLACING THE WEARING SURFACE AROUND FLOOR DRAINS SO AS NOT TO HINDER EFFECTIVE DRAINAGE. ALL DRAINS SHALL BE LEFT OPEN. THE PROPOSED WEARING SURFACE SHALL VARY IN THICKNESS AS NECESSARY TO PROVIDE A SMOOTH RIDING SURFACE. A THICKNESS OF NOT LESS THAN  $\frac{5}{8}$ " SHALL BE PROVIDED. THE MAXIMUM THICKNESS SHALL PREFERABLY BE 1-1/2" UNLESS IT IS IMPRACTICAL TO PROVIDE A SMOOTH RIDING SURFACE OTHERWISE.

**NOTES**

ALL UNPAVED S.R. ROUTES TO BE SURFACED 50' FROM EDGE OF PAVEMENT OF MAIN PROJECT.  
ALL PAVED S.R. ROUTES TO BE RESURFACED TO END OF RADDII, OR AS DIRECTED BY THE ENGINEER. EDGES, PAVEMENT WIDENING, INTERSECTIONS AND BRIDGE FLARES ARE INCLUDED IN THE SUMMARY OF QUANTITIES. BRIDGES TO BE RESURFACED AT LOCATIONS AND DEPTH AS DIRECTED BY THE ENGINEER.

**PAVEMENT SCHEDULE**

F1	PROPOSED ASPHALT SURFACE TREATMENT, DOUBLE SEAL
F2	PROPOSED FOG SEAL
U	EXISTING PAVEMENT



## SIGNING FOR ASPHALT SURFACE TREATMENT

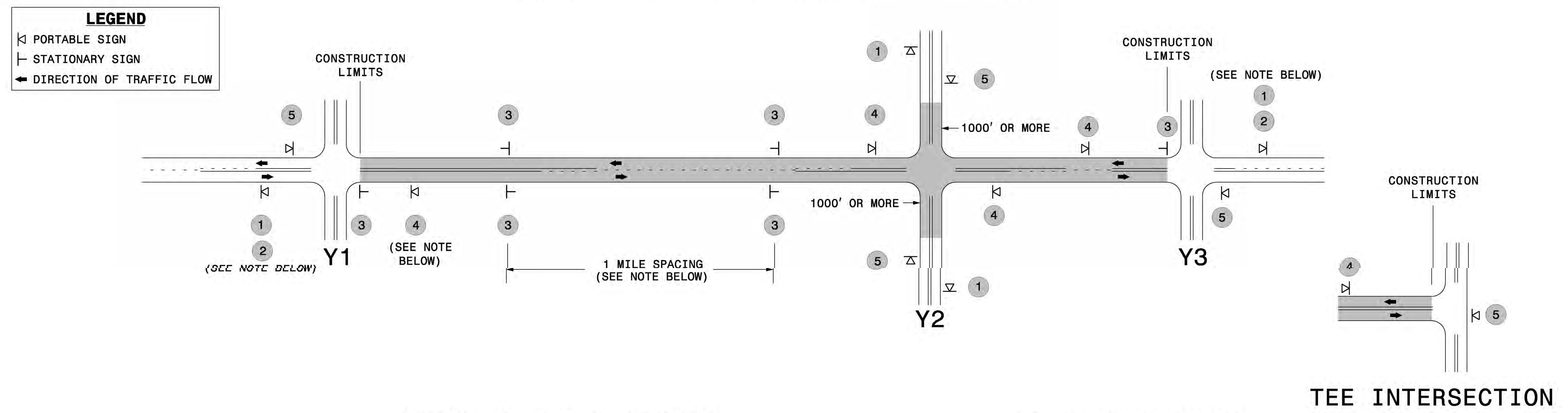

### MAINLINE (-L-) SIGNING

### -Y- LINE SIGNING

<b>SIGNING NOTES AND PLACEMENT PER DIRECTION</b>	1	 	<ul style="list-style-type: none"> <li>- PLACE 1000' PRIOR TO BEGINNING OF CONSTRUCTION LIMITS. ONLY USED ON -Y- LINES IF RESURFACING LIMITS EXTEND 1000' ALONG -Y- LINE.</li> <li>- SIGN #2 ONLY USED WHEN RESURFACING LIMITS ARE 2 OR MORE MILES IN LENGTH. ROUND UP TO THE NEAREST WHOLE NUMBER. DO NOT USE FRACTIONAL OR DECIMAL NUMBERS.</li> </ul>	<p><b>STATIONARY SIGNING NOT REQUIRED FOR THE FOLLOWING -Y- LINE CONDITIONS:</b></p> <ol style="list-style-type: none"> <li>1) LESS THAN 1000' OF RESURFACING ALONG -Y- LINE</li> <li>2) SUBDIVISION ROADS</li> <li>3) DEAD END ROADS</li> </ol> <p>WHEN PAVING/CONSTRUCTION ACTIVITIES PROCEED ACROSS AN UNSIGNED -Y- LINE, PORTABLE ADVANCE WARNING SIGNS SHALL BE USED ALONG THE -Y- LINE AS SHOWN BELOW. REMOVE UPON COMPLETION OF WORK.</p> <div style="display: flex; justify-content: space-around; align-items: center;"> <div style="text-align: center;">   <small>W20-1 48" X 48"</small>              PLACED 500' IN ADVANCE OF FLAGGER.         </div> <div style="text-align: center;">   <small>W20-7 A 48" X 48"</small>              PLACED 250' IN ADVANCE OF FLAGGER.         </div> </div>
	3	 	<ul style="list-style-type: none"> <li>- ALTERNATE THE FOLLOWING TWO SIGNS:</li> <li>- STARTING WITH "LOOSE GRAVEL" (W8-7) FOLLOWED BY "UNMARKED PAVEMENT".</li> <li>- PLACE INITIALLY AT THE CONSTRUCTION LIMITS AND SPACED 1 MILE APART THEREAFTER.</li> <li>- AT TEE INTERSECTIONS INSTALL INITIALLY 0.5 MILE FROM INTERSECTION AND SPACE 1 MILE APART THEREAFTER.</li> </ul>	
	4		<ul style="list-style-type: none"> <li>- THESE ARE FOR -Y- LINES THAT ARE "THROUGH" ROADWAYS. DEAD END AND SUBDIVISION ROADS ARE NOT "THROUGH" ROADWAYS.</li> <li>- INSTALL 500' +/- FROM EACH -Y- LINE APPROACH AS SHOWN ABOVE.</li> <li>- FOR MULTIPLE -Y- LINES THAT ARE SEPARATED BY 0.25 MILES OR LESS, TREAT AS A SINGLE UNIT AND INSTALL WITHIN 500' OF EACH APPROACH.</li> <li>- A MAXIMUM OF 2 SIGN SETS PER MILE. DO NOT INSTALL WHEN -Y- LINES ARE WITHIN 0.5 MILES FROM "END ROAD WORK" SIGN.</li> </ul>	
	5		<ul style="list-style-type: none"> <li>- PLACE 500' FOLLOWING THE END OF CONSTRUCTION LIMITS OR AS SHOWN WHEN WORK ENDS AT A 3-WAY TEE INTERSECTION.</li> </ul>	
	<p>THE ABOVE SIGNS ARE ALL THAT ARE REQUIRED FOR A CONTRACTOR TO BEGIN A RESURFACING CONTRACT. ANY ADDITIONAL SIGNS REQUESTED BY NCDOT DIVISIONS SHALL BE INSTALLED WITHIN 7 BUSINESS DAYS OF THE START OF CONTRACT WORK.</p>			

**MAPS LESS THAN 2 MILES**

FOR AST RESURFACING MAPS WITH CONSTRUCTION LIMITS LESS THAN 2 MILES IN LENGTH, USE A STATIONARY "LOOSE GRAVEL" SIGN AT THE BEGINNING CONSTRUCTION LIMIT FOLLOWED BY AN "UNMARKED PAVEMENT" SIGN MIDWAY THROUGH AND AN "END ROAD WORK" SIGN AT THE END CONSTRUCTION LIMIT.

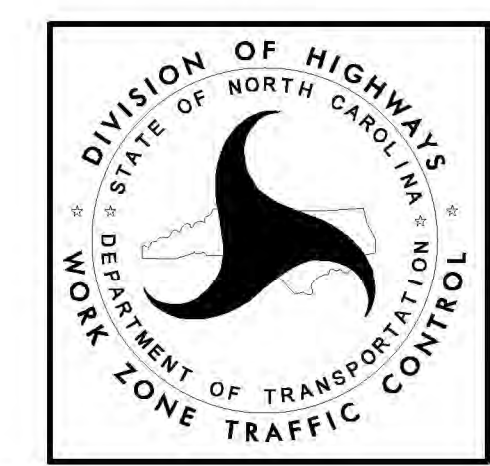

**ADVANCE WARNING SIGNS FOR 2-LANE ROADWAY ASPHALT SURFACE TREATMENT**

5/12/2017 S:\T\U\W\ZTC\Resurfacing\2L2W & AST Resurfacing Details\Resurfacing\_AdvWarn\_2Ln - AST.dgn User:kdalis

TIP NO.	SHEET NO.
DocuSigned by: <i>Matthew V. Springer</i>	
APPROVED:	8/13/2019
DATE:	6609-528B584403...
SEAL	
	

STATE OF NORTH CAROLINA  
DEPT. OF TRANSPORTATION  
DIVISION OF HIGHWAYS  
RALEIGH, N.C.

8-19

ENGLISH DETAIL DRAWING FOR  
PAVEMENT MARKINGS  
INTERSECTIONS

**TWO-LANE, TWO-WAY ROADWAY**

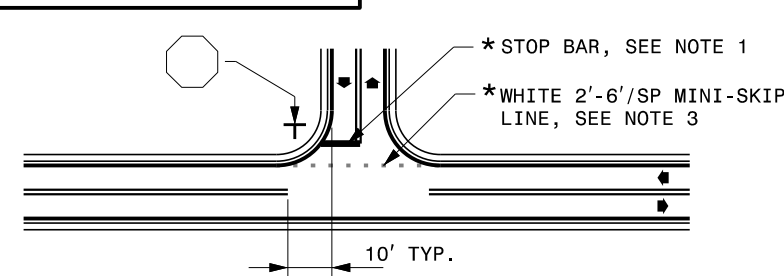

\* STOP BAR, SEE NOTE 1  
\* WHITE 2'-6"/SP MINI-SKIP LINE, SEE NOTE 3  
10' TYP.

**UNDIVIDED MULTI-LANE ROADWAY**

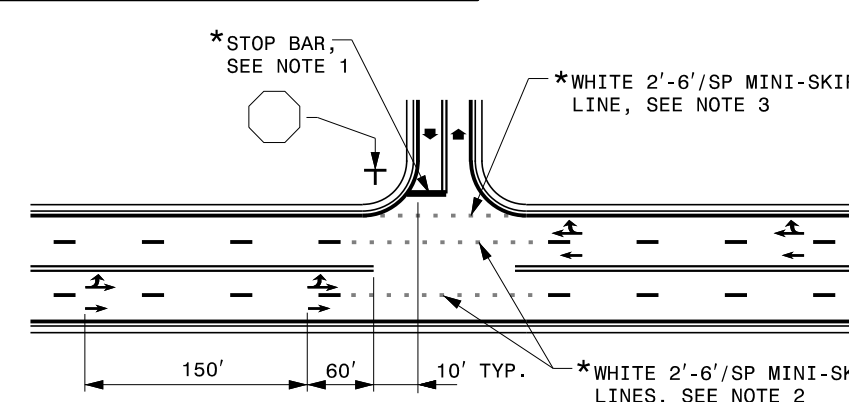

\* STOP BAR, SEE NOTE 1  
\* WHITE 2'-6"/SP MINI-SKIP LINE, SEE NOTE 3  
150' 60' 10' TYP.  
\* WHITE 2'-6"/SP MINI-SKIP LINES, SEE NOTE 2

**DIVIDED MULTI-LANE ROADWAY WITH WIDE MEDIAN CROSSOVER**

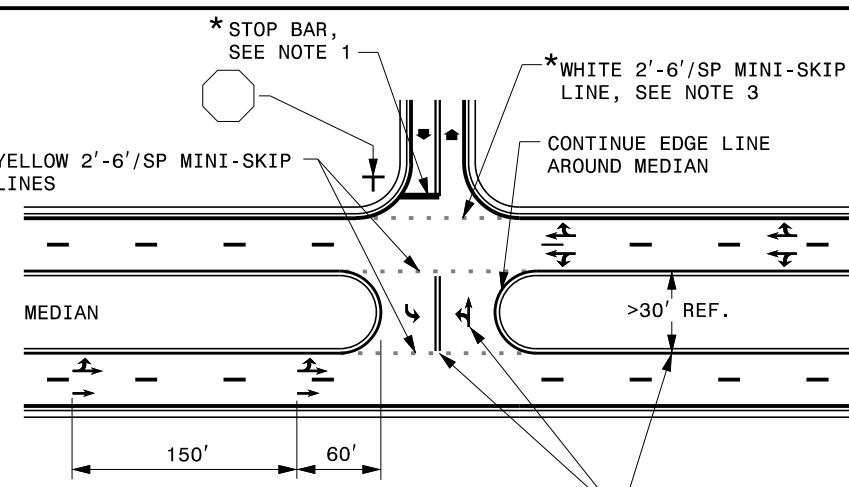

\* STOP BAR, SEE NOTE 1  
\* WHITE 2'-6"/SP MINI-SKIP LINE, SEE NOTE 3  
CONTINUE EDGE LINE AROUND MEDIAN  
YELLOW 2'-6"/SP MINI-SKIP LINES  
MEDIAN  
>30' REF.  
150' 60'

USE DOUBLE YELLOW CENTER LINE AND ARROW SYMBOLS IN MEDIAN CROSSOVER WHEN WIDTH OF MEDIAN EXCEEDS 30 FT, OTHERWISE THEY ARE NOT REQUIRED.

STATE OF NORTH CAROLINA  
DEPT. OF TRANSPORTATION  
DIVISION OF HIGHWAYS  
RALEIGH, N.C.

8-19

ENGLISH DETAIL DRAWING FOR  
PAVEMENT MARKINGS  
INTERSECTIONS

**TWO-LANE, TWO-WAY ROADWAY WITH TWO-WAY LEFT TURN LANE**

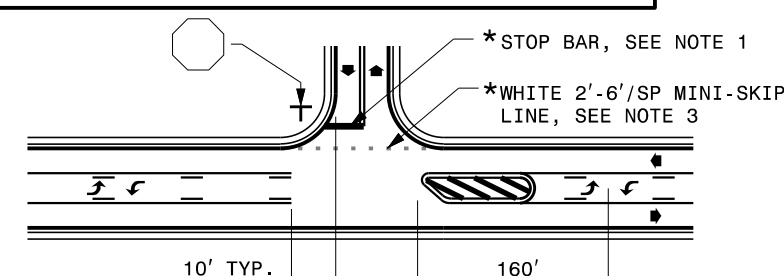

\* STOP BAR, SEE NOTE 1  
\* WHITE 2'-6"/SP MINI-SKIP LINE, SEE NOTE 3  
10' TYP. 160'

**DIVIDED MULTI-LANE ROADWAY WITH TURN BAY**

MONOLITHIC ISLANDS SHALL BE DELINEATED BY ONE OR MORE OF THE FOLLOWING METHODS:  
MARKED WITH EDGE LINES, A RETROREFLECTIVE COATING APPLIED TO ISLAND EDGES OR APPROVED DELINEATION DEVICES

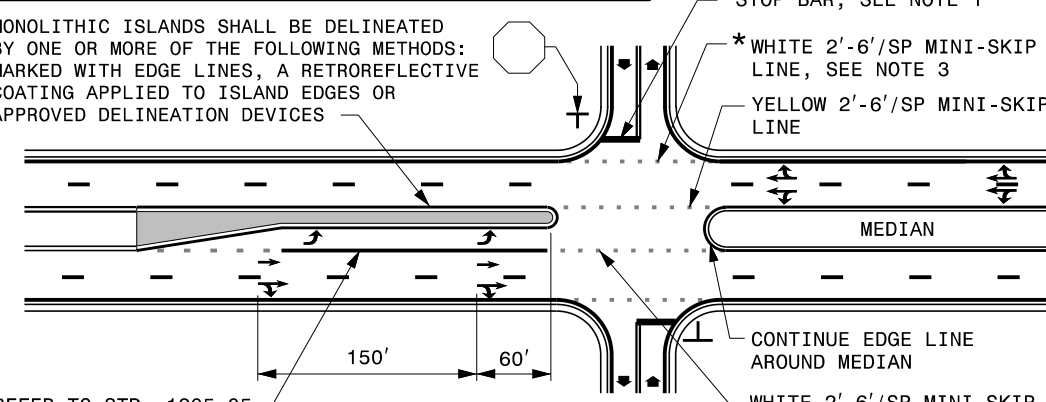





\* STOP BAR, SEE NOTE 1  
\* WHITE 2'-6"/SP MINI-SKIP LINE, SEE NOTE 3  
YELLOW 2'-6"/SP MINI-SKIP LINE  
MEDIAN  
CONTINUE EDGE LINE AROUND MEDIAN  
WHITE 2'-6"/SP MINI-SKIP LINE  
150' 60'

REFER TO STD. 1205.05 FOR TURN LANE MARKING GUIDANCE

**GENERAL NOTES:**

- 1- PLACEMENT OF STOP BARS AT NON-SIGNALIZED INTERSECTIONS IS OPTIONAL AND USED WHERE IT IS IMPORTANT TO INDICATE THE POINT WHICH VEHICLES ARE REQUIRED TO STOP. PLACE STOP BARS NO LESS THAN 4 FEET AND NO MORE THAN 30 FEET FROM THE NEAREST EDGE OF THE INTERSECTING ROADWAY. USE 10 FEET AS THE TYPICAL SETBACK DISTANCE OR AS DIRECTED BY THE ENGINEER.
- 2- MINI-SKIP LANE LINE EXTENSIONS SHOULD BE USED AT INTERSECTIONS THAT HAVE REDUCED VISIBILITY CONDITIONS SUCH AS OFFSET, SKEWED, OR CURVED ROADWAYS.
- 3- MINI-SKIP EDGE LINE EXTENSIONS MAY BE PLACED THROUGH INTERSECTIONS AND MAJOR DRIVEWAYS.
- 4- REFER TO ROADWAY STANDARD DRAWINGS 1205.01, 1205.02, 1205.05, 1205.08 AND 1205.09 FOR ADDITIONAL PAVEMENT MARKING GUIDANCE.

**LEGEND**

 STOP SIGN	 STATIONARY SIGN
 DIRECTION OF TRAFFIC FLOW	 PAVEMENT MARKING SYMBOLS
* OPTIONAL	

SHEET 2 OF 2  
**1205D04**

SHEET 2 OF 2  
**1205D04**

**REVISED PAVEMENT MARKING  
ROADWAY STANDARD DRAWING**

U:\8\13\17\Standards Group\Standards and Drawings\Drawings\2018 Standard Dwg\Division 12 Final\2050402\_08-13-19.dgn  
User:dstokes



PROJECT NO.	SHEET NO.	TOTAL NO.
2024CPT.07.06.20172, ETC.	7	8

## SUMMARY OF QUANTITIES

PROJECT NO	COUNTY	MAP NO	ROUTE	DESCRIPTION	LENGTH	WIDTH	1803500000-E	1820000000-E	1838000000-E	1838500000-N	4413000000-E	4457000000-N	4725000000-E				4890000000-E			
							ASPHALT SURFACE TREATMENT, DOUBLE SEAL	ASPHALT SURFACE TREATMENT, FOG SEAL	EMULSION FOR ASPHALT SURFACE TREATMENT	VACUUM TRUCK	WORK ZONE ADVANCE/ GENERAL WARNING SIGNING	TEMPORARY TRAFFIC CONTROL	THERMO LT ARROW 90 M	THERMO RT ARROW 90 M	8" HOT SPRAY THERMO (YELLOW)	6" HOT SPRAY THERMO (WHITE)	4" HOT SPRAY THERMO (WHITE)	4" HOT SPRAY THERMO (YELLOW)		
							SY	SY	GAL	WK	SF	LS	EA	EA	LF	LF	LF	LF		
2024CPT.07.06.20172	Caswell	1	SR-1773 / WADE DEAD END RD	FROM ORANGE CO LINE TO DEAD END	0.78	20	9,133	9,133	5,023									8,220	6,890	
<b>TOTAL FOR MAP NO. 1</b>					<b>0.78</b>		<b>9,133</b>	<b>9,133</b>	<b>5,023</b>									<b>8,220</b>	<b>6,890</b>	
<b>TOTAL FOR PROJ NO. 2024CPT.07.06.20172</b>					<b>0.78</b>		<b>9,133</b>	<b>9,133</b>	<b>5,023</b>									<b>8,220</b>	<b>6,890</b>	
2024CPT.07.06.20012	Alamance	2	SR-1914 / HIGH ROCK RD	FROM SR 1913 - LYNCH STORE RD TO ORANGE CO LINE	0.17	21	2,123	2,123	1,168									1,820	1,820	
<b>TOTAL FOR MAP NO. 2</b>					<b>0.17</b>		<b>2,123</b>	<b>2,123</b>	<b>1,168</b>									<b>1,820</b>	<b>1,820</b>	
2024CPT.07.06.20012	Alamance	3	SR-1989 / MT ZION CHURCH RD	FROM NC 49 TO ORANGE CO LINE	0.26	20	3,078	3,078	1,693									216	2,770	
<b>TOTAL FOR MAP NO. 3</b>					<b>0.26</b>		<b>3,078</b>	<b>3,078</b>	<b>1,693</b>									<b>216</b>	<b>2,770</b>	
<b>TOTAL FOR PROJ NO. 2024CPT.07.06.20012</b>					<b>0.43</b>		<b>5,201</b>	<b>5,201</b>	<b>2,861</b>									<b>216</b>	<b>4,590</b>	
2024CPT.07.06.20682	Orange	4	SR-1324 / BROOKHOLLOW RD	FROM US 70 TO SR 1306 - LEBANON RD	1.61	20	18,849	18,849	10,367									16,964	16,964	
<b>TOTAL FOR MAP NO. 4</b>					<b>1.61</b>		<b>18,849</b>	<b>18,849</b>	<b>10,367</b>									<b>16,964</b>	<b>16,964</b>	
2024CPT.07.06.20682	Orange	5	SR-1338 / BROOKHOLLOW RD	FROM SR 1004 - EFLAND CEDAR GROVE RD TO SR 1306 - LEBANON RD	1.99	20	23,344	23,344	12,839									92	21,010	
<b>TOTAL FOR MAP NO. 5</b>					<b>1.99</b>		<b>23,344</b>	<b>23,344</b>	<b>12,839</b>									<b>92</b>	<b>21,010</b>	
2024CPT.07.06.20682	Orange	6	SR-1367 / CLAIBORNES RD	FROM SR 1004 CORBETT RIDGE RD TO ALAMANCE COUNTY LINE	0.98	20	11,544	11,544	6,349									20	10,390	
<b>TOTAL FOR MAP NO. 6</b>					<b>0.98</b>		<b>11,544</b>	<b>11,544</b>	<b>6,349</b>									<b>20</b>	<b>10,390</b>	
2024CPT.07.06.20682	Orange	7	SR-1350 / HARMONY CHURCH RD	FROM SR 1364 - LYNCH STORE RD TO SR 1350 - LONESOME RD/SR 1341 HARMONY CHURCH RD	1.52	21	18,748	18,748	10,312									36	16,070	
<b>TOTAL FOR MAP NO. 7</b>					<b>1.52</b>		<b>18,748</b>	<b>18,748</b>	<b>10,312</b>									<b>36</b>	<b>16,070</b>	
2024CPT.07.06.20682	Orange	8	SR-1341 / HARMONY CHURCH RD	FROM SR 1350 - LONESOME RD TO SR 1339 - HARMONY CHURCH RD	3.92	21	48,312	48,312	26,571									116	41,410	
<b>TOTAL FOR MAP NO. 8</b>					<b>3.92</b>		<b>48,312</b>	<b>48,312</b>	<b>26,571</b>									<b>116</b>	<b>41,410</b>	
2024CPT.07.06.20682	Orange	9	SR-1339 / HARMONY CHURCH RD	FROM SR 1341 - HARMONY CHURCH RD TO SR 1004 - EFLAND CEDAR GROVE RD	0.79	21	9,730	9,730	5,352										8,340	
<b>TOTAL FOR MAP NO. 9</b>					<b>0.79</b>		<b>9,730</b>	<b>9,730</b>	<b>5,352</b>										<b>8,340</b>	
2024CPT.07.06.20682	Orange	10	SR-1362 / ALLIE MAE RD	FROM SR 1004 - CARR STORE RD TO SR 1361 - PENTECOST RD	1.41	20	16,493	16,493	9,071										14,844	
<b>TOTAL FOR MAP NO. 10</b>					<b>1.41</b>		<b>16,493</b>	<b>16,493</b>	<b>9,071</b>										<b>14,844</b>	
2024CPT.07.06.20682	Orange	11	SR-1336 / HALLS MILL RD	FROM SR 1332 - HIGHLAND FARM RD TO SR 1004 - EFLAND CEDAR GROVE RD	1.85	20	21,744	21,744	11,959										19,570	
<b>TOTAL FOR MAP NO. 11</b>					<b>1.85</b>		<b>21,744</b>	<b>21,744</b>	<b>11,959</b>										<b>19,570</b>	
2024CPT.07.06.20682	Orange	12	SR-1335 / KENION RD	FROM NC 86 TO SR 1332 - HIGHLAND FARM RD	1.71	19	19,084	19,084	10,496										18,080	
<b>TOTAL FOR MAP NO. 12</b>					<b>1.71</b>		<b>19,084</b>	<b>19,084</b>	<b>10,496</b>										<b>18,080</b>	
2024CPT.07.06.20682	Orange	13	SR-1337 / BANE RD	FROM SR 1336 - HALLS MILL RD TO SR 1338 - BROOKHOLLOW RD	0.84	19	9,384	9,384	5,161										8,890	
<b>TOTAL FOR MAP NO. 13</b>					<b>0.84</b>		<b>9,384</b>	<b>9,384</b>	<b>5,161</b>										<b>8,890</b>	
2024CPT.07.06.20682	Orange	14	SR-1306 / LEBANON RD	FROM SR 1004 - EFLAND CEDAR GROVE RD TO DEAD END	1.81	20	21,167	21,167	11,642										19,050	
<b>TOTAL FOR MAP NO. 14</b>					<b>1.81</b>		<b>21,167</b>	<b>21,167</b>	<b>11,642</b>										<b>19,050</b>	
2024CPT.07.06.20682	Orange	15	SR-1391 / BLACKSMITH RD	FROM SR 1306 - LEBANON RD TO END PVMT	0.26	20	3,067	3,067	1,687											
<b>TOTAL FOR MAP NO. 15</b>					<b>0.26</b>		<b>3,067</b>	<b>3,067</b>	<b>1,687</b>											
2024CPT.07.06.20682	Orange	16	SR-1325 / N OAK ST	FROM US 70 TO CUL-DE-SAC	0.20	19	2,263	2,263	1,245											
<b>TOTAL FOR MAP NO. 16</b>					<b>0.20</b>		<b>2,263</b>	<b>2,263</b>	<b>1,245</b>											
2024CPT.07.06.20682	Orange	17	SR-1400 / GREGG ST	FROM SR 1312 - RICHMOND RD TO END PVMT	0.20	19	2,248	2,248	1,237											
<b>TOTAL FOR MAP NO. 17</b>					<b>0.20</b>		<b>2,248</b>	<b>2,248</b>	<b>1,237</b>											
2024CPT.07.06.20682	Orange	18	SR-1463 / CAIN DR	FROM SR 1400 - GREGG ST TO END PVMT	0.13	19	1,410	1,410	776											
<b>TOTAL FOR MAP NO. 18</b>					<b>0.13</b>		<b>1,410</b>	<b>1,410</b>	<b>776</b>											
2024CPT.07.06.20682	Orange	19	SR-1308 / HOOVER RD	FROM US 70 TO END PVMT	0.45	20	5,233	5,233	2,878											
<b>TOTAL FOR MAP NO. 19</b>					<b>0.45</b>		<b>5,233</b>	<b>5,233</b>	<b>2,878</b>											
2024CPT.07.06.20682	Orange	20	SR-1379 / FRANK PERRY RD	FROM SR 1332 COLEMAN LOOP RD TO SR 1328 FAUCETTE MILL RD	1.33	20	15,556	15,556	8,556										14,000	
<b>TOTAL FOR MAP NO. 20</b>					<b>1.33</b>		<b>15,556</b>	<b>15,556</b>	<b>8,556</b>										<b>14,000</b>	
2024CPT.07.06.20682	Orange	21	SR-1383 / ENO CEMETERY RD	FROM SR 1352 - CARR STORE RD TO CUL-DE-SAC	1.07	20	12,500	12,500	6,875										11,250	
<b>TOTAL FOR MAP NO. 21</b>					<b>1.07</b>		<b>12,500</b>	<b>12,500</b>	<b>6,875</b>										<b>11,250</b>	
2024CPT.07.06.20682	Orange	22	SR-1353 / COMPTON RD	FROM NC 86 TO SR 1352 - CARR STORE RD	2.16	20	25,300	25,300	13,915										22,770	
<b>TOTAL FOR MAP NO. 22</b>					<b>2.16</b>		<b>25,300</b>	<b>25,300</b>	<b>13,915</b>										<b>22,770</b>	
2024CPT.07.06.20682	Orange	23	SR-1360 / LEES CHAPEL RD	FROM SR 1357 - EFLAND CEDAR GROVE RD TO SR 1004 - CARR STORE RD	1.28	20	15,000	15,000	8,250										13,500	
<b>TOTAL FOR MAP NO. 23</b>					<b>1.28</b>		<b>15,000</b>	<b>15,000</b>	<b>8,250</b>										<b>13,500</b>	
2024CPT.07.06.20682	Orange	24	SR-1358 / MCDADE STORE RD	FROM SR 1357 - EFLAND CEDAR GROVE RD TO SR 1361 - PENTECOST RD	2.14	21	26,355	26,355	14,495										22,590	
<b>TOTAL FOR MAP NO. 24</b>					<b>2.14</b>		<b>26,355</b>	<b>26,355</b>	<b>14,495</b>										<b>22,590</b>	
2024CPT.07.06.20682	Orange	25	SR-1361 / MCDADE STORE RD	FROM NC 49 TO SR 1358 - MCDADE STORE RD	1.00	21	12,273	12,273	6,750										10,520	
<b>TOTAL FOR MAP NO. 25</b>					<b>1.00</b>		<b>12,273</b>	<b>12,273</b>	<b>6,750</b>										<b>10,520</b>	
2024CPT.07.06.20682	Orange	26	SR-1371 / MCCULLOUGH RD	FROM SR 1361 - MCDADE STORE RD TO NC 86	0.94	20	11,067	11,067	6,087										9,960	
<b>TOTAL FOR MAP NO. 26</b>					<b>0.94</b>		<b>11,067</b>	<b>11,067</b>	<b>6,087</b>										<b>9,960</b>	



PROJECT NO.	SHEET NO.	TOTAL NO.
2024CPT.07.06.20172, ETC.	7	8

## SUMMARY OF QUANTITIES

PROJECT NO	COUNTY	MAP NO	ROUTE	DESCRIPTION	LENGTH	WIDTH	1803500000-E	1820000000-E	1838000000-E	1838500000-N	4413000000-E	4457000000-N	4725000000-E		4890000000-E					
							ASPHALT SURFACE TREATMENT, DOUBLE SEAL	ASPHALT SURFACE TREATMENT, FOG SEAL	EMULSION FOR ASPHALT SURFACE TREATMENT	VACUUM TRUCK	WORK ZONE ADVANCE/ GENERAL WARNING SIGNING	TEMPORARY TRAFFIC CONTROL	THERMO LT ARROW 90 M	THERMO RT ARROW 90 M	8" HOT SPRAY THERMO (YELLOW)	6" HOT SPRAY THERMO (WHITE)	4" HOT SPRAY THERMO (WHITE)	4" HOT SPRAY THERMO (YELLOW)		
							SY	SY	GAL	WK	SF	LS	EA	EA	LF	LF	LF	LF		
2024CPT.07.06.20682	Orange	27	SR-1422 / MCCULLOUGH RD	FROM NC 49 TO SR 1361 - MCDADE STORE RD	0.36	20	4,178	4,178	2,298									3,760	3,760	
<b>TOTAL FOR MAP NO. 27</b>					<b>0.36</b>		<b>4,178</b>	<b>4,178</b>	<b>2,298</b>			<b>40</b>						<b>3,760</b>	<b>3,760</b>	
2024CPT.07.06.20682	Orange	28	SR-1361 / PENTECOST RD	FROM SR 1358 - MCDADE STORE RD TO SR 1364 - LYNCH STORE RD	4.01	20	47,089	47,089	25,899									42,380	42,380	
<b>TOTAL FOR MAP NO. 28</b>					<b>4.01</b>		<b>47,089</b>	<b>47,089</b>	<b>25,899</b>			<b>450</b>						<b>42,380</b>	<b>42,380</b>	
2024CPT.07.06.20682	Orange	29	SR-1368 / WADE LOOP	FROM NC 49 TO NC 49	2.42	20	28,422	28,422	15,632									25,580	23,963	
<b>TOTAL FOR MAP NO. 29</b>					<b>2.42</b>		<b>28,422</b>	<b>28,422</b>	<b>15,632</b>			<b>272</b>						<b>25,580</b>	<b>23,963</b>	
2024CPT.07.06.20682	Orange	30	SR-1369 / WADES DEAD END	FROM SR 1368 - WADE LOOP TO CASWELL COUNTY	0.78	20	9,089	9,089	4,999									8,180	7,148	
<b>TOTAL FOR MAP NO. 30</b>					<b>0.78</b>		<b>9,089</b>	<b>9,089</b>	<b>4,999</b>			<b>87</b>						<b>8,180</b>	<b>7,148</b>	
2024CPT.07.06.20682	Orange	31	SR-1370 / DOC CORBETT RD	FROM SR 1004 CARR STORE RD TO SR 1361 PENTECOST RD	0.99	19	11,052	11,052	6,078									10,470	10,470	
<b>TOTAL FOR MAP NO. 31</b>					<b>0.99</b>		<b>11,052</b>	<b>11,052</b>	<b>6,078</b>			<b>112</b>						<b>10,470</b>	<b>10,470</b>	
2024CPT.07.06.20682	Orange	32	SR-1363 / DOC CORBETT RD	FROM SR 1364 LYNCH STORE RD TO SR 1004 CARR STORE RD	1.92	19	21,348	21,348	11,741									20,224	20,224	
<b>TOTAL FOR MAP NO. 32</b>					<b>1.92</b>		<b>21,348</b>	<b>21,348</b>	<b>11,741</b>			<b>215</b>						<b>20,224</b>	<b>20,224</b>	
2024CPT.07.06.20682	Orange	33	SR-1349 / POTEAT RD	FROM SR 1341 - HARMONY CHURCH RD TO SR 1350 - LONESOME RD	1.16	19	12,962	12,962	7,129									12,280	12,280	
<b>TOTAL FOR MAP NO. 33</b>					<b>1.16</b>		<b>12,962</b>	<b>12,962</b>	<b>7,129</b>			<b>131</b>						<b>12,280</b>	<b>12,280</b>	
2024CPT.07.06.20682	Orange	34	SR-1350 / LONESOME RD	FROM SR 1341 - HARMONY CHURCH RD TO SR 1343 - MILL CREEK RD	1.70	20	19,918	19,918	10,955									17,926	17,926	
<b>TOTAL FOR MAP NO. 34</b>					<b>1.70</b>		<b>19,918</b>	<b>19,918</b>	<b>10,955</b>			<b>191</b>						<b>17,926</b>	<b>17,926</b>	
2024CPT.07.06.20682	Orange	35	SR-1421 / LIB RD	FROM SR 1361 - PENTECOST RD TO SR 1350 - LONESOME RD	0.87	19	9,724	9,724	5,348									9,212	9,212	
<b>TOTAL FOR MAP NO. 35</b>					<b>0.87</b>		<b>9,724</b>	<b>9,724</b>	<b>5,348</b>			<b>98</b>						<b>9,212</b>	<b>9,212</b>	
2024CPT.07.06.20682	Orange	36	SR-1351 / GOVERNOR SCOTT RD	FROM SR 1343 - MILL CREEK RD TO SR 1004 - EFLAND CEDAR GROVE RD	2.55	20	31,436	31,436	18,159									2	2	
<b>TOTAL FOR MAP NO. 36</b>					<b>2.55</b>		<b>31,436</b>	<b>31,436</b>	<b>18,159</b>			<b>285</b>						<b>2</b>	<b>2</b>	
2024CPT.07.06.20682	Orange	37	SR-1365 / MT ZION CHURCH RD	FROM ALAMANCE CO TO SR 1364 - LYNCH STORE RD	1.07	19	11,974	11,974	6,586									11,344	11,344	
<b>TOTAL FOR MAP NO. 37</b>					<b>1.07</b>		<b>11,974</b>	<b>11,974</b>	<b>6,586</b>			<b>121</b>						<b>11,344</b>	<b>11,344</b>	
2024CPT.07.06.20682	Orange	38	SR-1366 / ATKINS RD	FROM NC 49 TO SR 1004 - CORBETT RIDGE RD	2.57	19	28,637	28,637	15,750									27,130	27,130	
<b>TOTAL FOR MAP NO. 38</b>					<b>2.57</b>		<b>28,637</b>	<b>28,637</b>	<b>15,750</b>			<b>288</b>						<b>27,130</b>	<b>27,130</b>	
2024CPT.07.06.20682	Orange	39	SR-1340 / HIGH ROCK RD	FROM ALAMANCE CO TO SR 1306 - LEBANON RD	5.70	21	70,257	70,257	38,641									60,220	57,323	
<b>TOTAL FOR MAP NO. 39</b>					<b>5.70</b>		<b>70,257</b>	<b>70,257</b>	<b>38,641</b>			<b>639</b>						<b>60,220</b>	<b>57,323</b>	
2024CPT.07.06.20682	Orange	40	SR-1346 / SADDLE CLUB RD	FROM SR 1306 - LEBANON RD TO SR 1340 - HIGH ROCK RD	2.38	20	27,887	27,887	15,338									25,098	25,098	
<b>TOTAL FOR MAP NO. 40</b>					<b>2.38</b>		<b>27,887</b>	<b>27,887</b>	<b>15,338</b>			<b>267</b>						<b>25,098</b>	<b>25,098</b>	
2024CPT.07.06.20682	Orange	41	SR-1448 / TANYA DRIVE	FROM SR 1444 - CHERRY STREET TO SR 1445 - GLENN ST	0.26	19	2,934	2,934	1,614											
<b>TOTAL FOR MAP NO. 41</b>					<b>0.26</b>		<b>2,934</b>	<b>2,934</b>	<b>1,614</b>			<b>30</b>								
2024CPT.07.06.20682	Orange	42	SR-1445 / GLENN ST	FROM SR 1343 - MILL CREEK RD TO SR 1448 - TANYA DRIVE	0.08	19	834	834	459											
<b>TOTAL FOR MAP NO. 42</b>					<b>0.08</b>		<b>834</b>	<b>834</b>	<b>459</b>			<b>9</b>								
2024CPT.07.06.20682	Orange	43	SR-1444 / CHERRY STREET	FROM SR 1343 - MILL CREEK RD TO SR 1448 - TANYA DRIVE	0.09	18	920	920	506											
<b>TOTAL FOR MAP NO. 43</b>					<b>0.09</b>		<b>920</b>	<b>920</b>	<b>506</b>			<b>10</b>								
2024CPT.07.06.20682	Orange	44	SR-1344 / DOE RUN RD	FROM SR 1345-SR 1343 MILL CREEK RD TO CUL-DE-SAC	0.49	19	5,451	5,451	2,998											
<b>TOTAL FOR MAP NO. 44</b>					<b>0.49</b>		<b>5,451</b>	<b>5,451</b>	<b>2,998</b>			<b>55</b>								
2024CPT.07.06.20682	Orange	45	SR-1343 / DOE RUN RD	FROM SR 1306 - LEBANON RD TO SR 1345-SR 1343 MILL CREEK RD	0.36	19	4,022	4,022	2,212									3,810	3,810	
<b>TOTAL FOR MAP NO. 45</b>					<b>0.36</b>		<b>4,022</b>	<b>4,022</b>	<b>2,212</b>			<b>41</b>						<b>3,810</b>	<b>3,810</b>	
2024CPT.07.06.20682	Orange	46	SR-1405 / POPLAR DR / MAPLE AVE	FROM SR 1340 - HIGH ROCK RD TO SR 1340 - HIGH ROCK RD	1.19	19	13,277	13,277	7,302									12,578	12,578	
<b>TOTAL FOR MAP NO. 46</b>					<b>1.19</b>		<b>13,277</b>	<b>13,277</b>	<b>7,302</b>			<b>134</b>						<b>12,578</b>	<b>12,578</b>	
2024CPT.07.06.20682	Orange	47	SR-1341 / IRA RD	FROM SR 1306 - LEBANON RD TO SR 1340 - HIGH ROCK RD	1.07	19	11,915	11,915	6,553									11,288	10,910	
<b>TOTAL FOR MAP NO. 47</b>					<b>1.07</b>		<b>11,915</b>	<b>11,915</b>	<b>6,553</b>			<b>120</b>						<b>11,288</b>	<b>10,910</b>	
2024CPT.07.06.20682	Orange	48	SR-1341 / IRA RD	FROM SR 1340 - HIGH ROCK RD TO SR 1339 - HARMONY CHURCH RD	0.58	19	6,496	6,496	3,573									6,154	6,154	
<b>TOTAL FOR MAP NO. 48</b>					<b>0.58</b>		<b>6,496</b>	<b>6,496</b>	<b>3,573</b>			<b>66</b>						<b>6,154</b>	<b>6,154</b>	
2024CPT.07.06.20682	Orange	49	SR-1312 / RICHMOND RD	FROM US 70 TO SR 1306 - LEBANON RD	1.70	19	18,905	18,905	10,398									17,910	17,505	
<b>TOTAL FOR MAP NO. 49</b>					<b>1.70</b>		<b>18,905</b>	<b>18,905</b>	<b>10,398</b>			<b>190</b>						<b>17,910</b>	<b>17,505</b>	
2024CPT.07.06.20682	Orange	50	SR-1347 / CHARLIES DEAD END RD	FROM SR 1343 - MILL CREEK RD TO END PVMIT	0.48	18	5,088	5,088	2,798											
<b>TOTAL FOR MAP NO. 50</b>					<b>0.48</b>		<b>5,088</b>	<b>5,088</b>	<b>2,798</b>			<b>54</b>								
2024CPT.07.06.20682	Orange	51	SR-1414 / POPLAR DR	FROM SR 1340 - HIGH ROCK RD TO END PAVEMENT	0.35	19	3,901	3,901	2,146											
<b>TOTAL FOR MAP NO. 51</b>					<b>0.35</b>		<b>3,901</b>	<b>3,901</b>	<b>2,146</b>			<b>40</b>								
<b>TOTAL FOR PROJ NO. 2024CPT.07.06.20682</b>					<b>64.72</b>		<b>758,387</b>	<b>758,387</b>	<b>417,982</b>			<b>7,269</b>			<b>2</b>	<b>2</b>	<b>280</b>	<b>612</b>	<b>651,902</b>	<b>642,964</b>
<b>GRAND TOTAL</b>					<b>65.93</b>		<b>772,721</b>	<b>772,721</b>	<b>425,866</b>	<b>8</b>		<b>7,407</b>	<b>1</b>	<b>2</b>	<b>2</b>	<b>280</b>	<b>828</b>	<b>664,712</b>	<b>654,444</b>	